

NEW!



ENOC CT CABLE TRAY SYSTEM

SMART AND EFFICIENT CABLE HANDLING



WIDE RANGE
Premium, Standard
& Basic

QUALITY
Metal tray with plastic
fingers and metal lid

TWO SIZES
Available in 42HU &
47HU version

FAST DELIVERY
Available for immediate
delivery

Enoc CT is a wide range, high end cable management system, designed for easier organizing and handling of large volumes of cables. It fits tool-free in the 19" profile of our F1/S1 enclosure. Its wide range gives you a premium model with many functions and possibilities down to standard and basic models where economy is important without sacrificing quality. Enoc CT gives you cable management solutions and accessories that best meet your different needs. Because at Enoc we are committed to finding the solution that best fits you. That is why we call it "The Enoc Way".

ENOC SYSTEM . COM

ENOC



TECHNICAL INFORMATION CT CABLE TRAY SYSTEM

CT1



CTH



CTD S/L

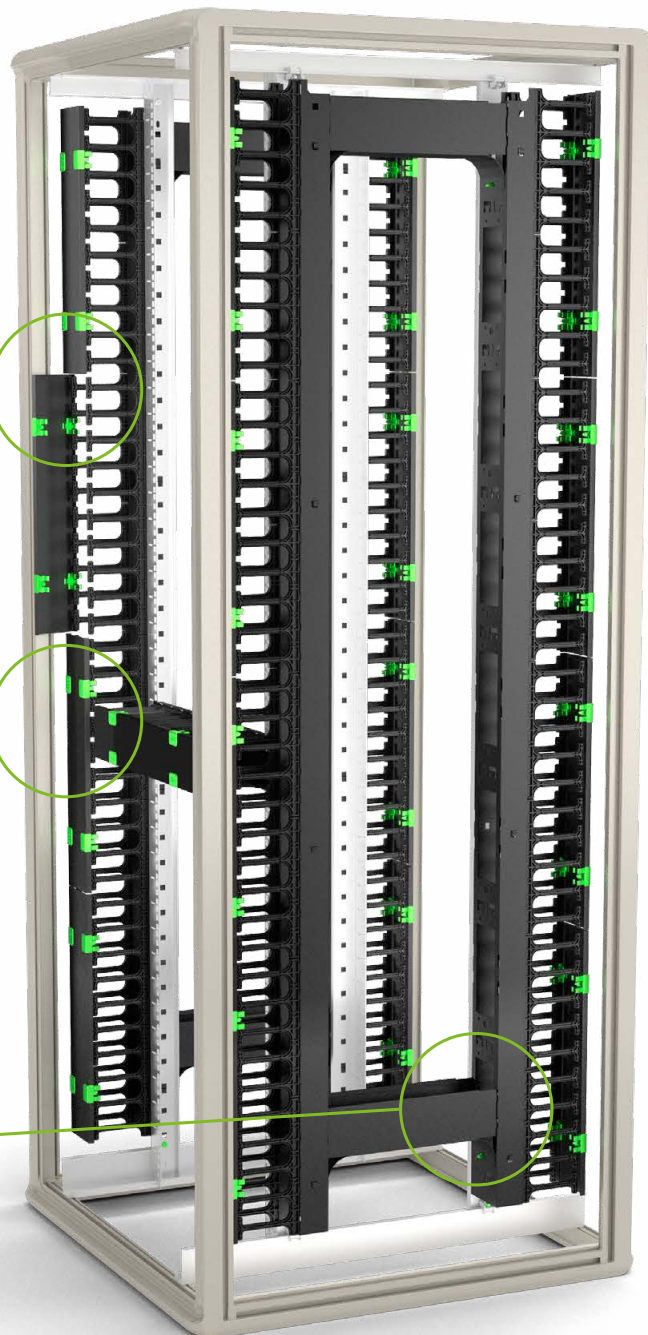

THE ENOC CABLE TRAY SYSTEM MEETS YOUR DIFFERENT NEEDS

CT1 Cable Tray Vertical with premium functions and possibilities.

CT3 Cable Tray Vertical with standard functions, delivered as a pair.

CT5 Cable guide without tray, delivered as a pair.

CTH Cable Tray Horizontal. 19" 2HU cable tray.

CTD S Cable Tray Depth, size small. For supporting cables in the depth direction.

CTD L Cable Tray Depth, size large. For supporting cables in the depth direction.



TECHNICAL INFORMATION

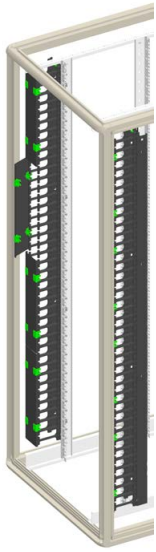

PREMIUM - CT1

High end vertical cable tray. Fits tool-free on the left and right side of the 19" profile in F1/S1 enclosure.

- Metal tray with plastic fingers and metal lid.
- Available in 42HU and 47HU version. 42HU version with 4 lids and 47HU version with 5 lids.
- Lids are hinged both left and right. They can also be removed completely.
- Back of tray has openings for cables going in the depth direction. It is also equipped with holes for cable holders.
- Possible to fit CTD S/L in the back of the tray.

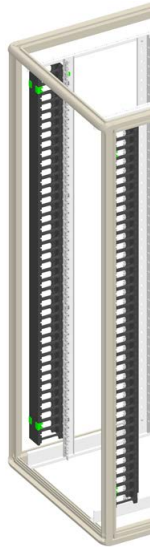
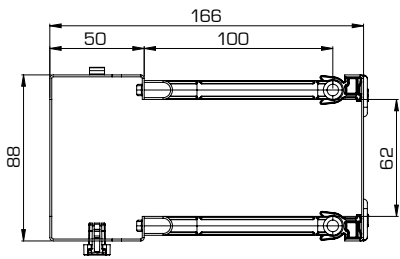

STANDARD - CT3

Standard vertical cable tray. Fits tool-free on the left and right side of the 19" profile in F1/S1 enclosure.

- Metal tray with plastic fingers and metal lid.
- Available in 42HU and 47HU version.
- One complete lid covering the whole height.
- Lid is hinged on both left and right. It can also be removed completely.
- Delivered as a pair, one left and one right CT3.

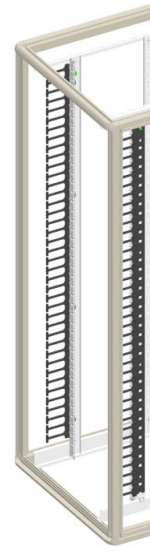
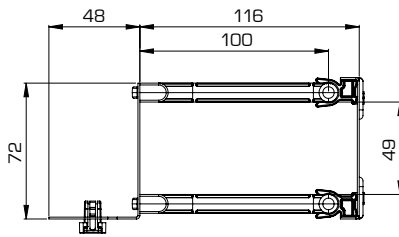

BASIC - CT5

Basic vertical cable manager without tray. Fits tool-free on the left and right side of the 19" profile in F1/S1 enclosure.

- Metal holder with plastic fingers.
- Available in 42HU and 47HU version.
- Delivered as a pair, one left and one right CT5.

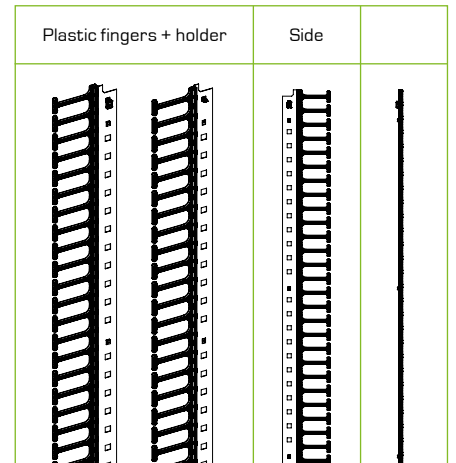
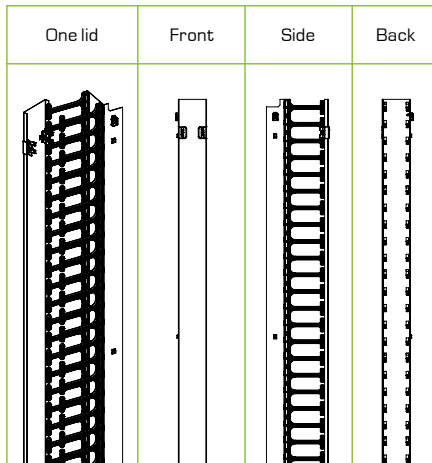
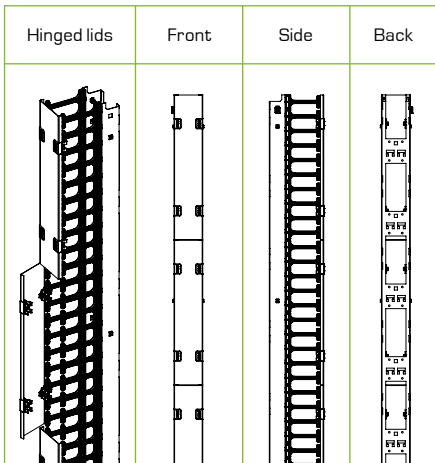
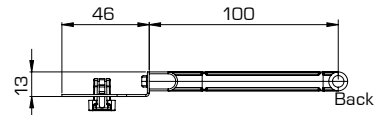



TECHNICAL INFORMATION AND DATA

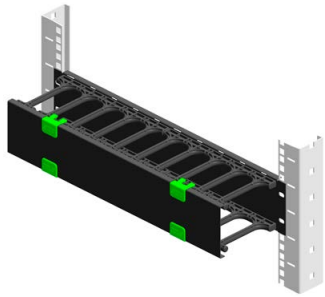

CTH

Cable tray horizontal. 19" 2HU cable tray using the same components as CT1.

- Metal tray with plastic fingers and metal lid.
- 2HU, 19" fixing.
- Lid is hinged both top and bottom and can be removed completely.

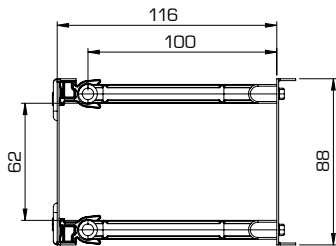

Hinged lid + plastic fingers	
Middle	
Back	

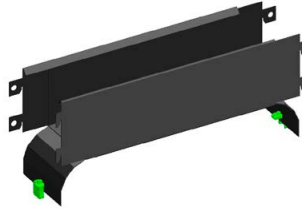

CTD S/L

Cable tray depth. For supporting cables in the depth direction. Either between two CT1:s or between one CT1 and a 19" profile.

- Stepless adjustable depth.
- Available in two sizes.
- CTD S, 300–450 mm depth.
- CTD L, 450–750 mm depth.
- Tool-free fixing in CT1.
- Cage nut required for fixing in 19" profile (not included).
- Bend radius control built in.

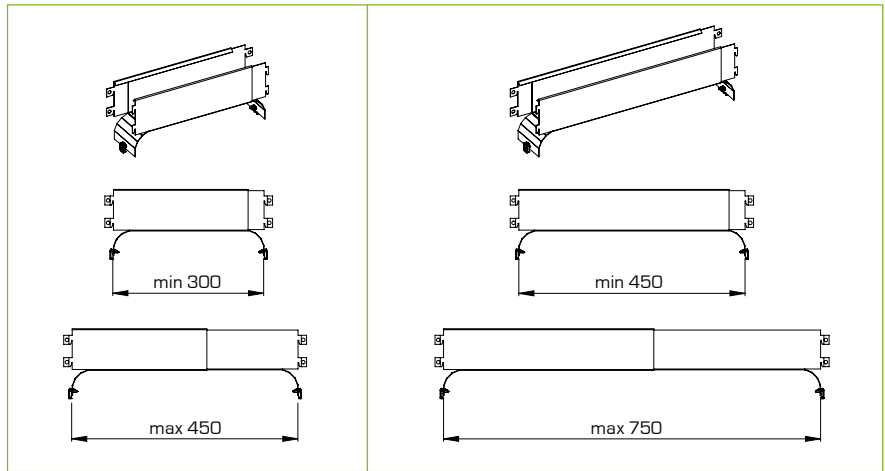
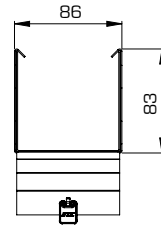

TECHNICAL DATA

NAME	ART. NO.	EAN	E NUMBER	W x D x H (mm)	REMARK
CT1 42	56875	7330701093746	2501235	88 x 166 x 1777	1 pcs, 2000 mm F1
CT1 47	56876	7330701093753	2501236	88 x 166 x 1998	1 pcs, 2200 mm F1
CT3 42	56881	7330701093807	2501237	75 x 165 x 1777	Pair, 2000 mm F1
CT3 47	56882	7330701093814	2501277	75 x 165 x 1998	Pair, 2200 mm F1
CT5 42	56886	7330701093852	2501238	13 x 151 x 1777	Pair, 2000 mm F1
CT5 47	56887	7330701093869	2501278	13 x 151 x 1998	Pair, 2200 mm F1
CTH	56891	7330701093906	2501239	482 x 126 x 88	19", 2HU
CTD S	56896	7330701093951	2501240	86 x 300 x 132	1 pcs, 300–450 mm
CTD L	56897	7330701093968	2501241	86 x 450 x 132	1 pcs, 450–700 mm